

Courses & distances
up Mill creek

N 32 Y	11
West	12
N 67 Y	20
N 52 Y	95
S 80 Y	17
N 69 Y	18
N 37 1/2 Y	52
N 42 Y	11
N 27 Y	15
N 72 Y	12
N 54 Y	195
North	6
N 51 Y	23
N 20 Y	8
N 15 Y	19
N 18 Y	10
N 11 E	10
N 18 Y	14
N 27 Y	12
West	7
N 3 Y	8
N 49 Y	11
N 76 Y	18
N 58 Y	125
N 27 Y	105
N 54 Y	7
N 15 Y	12
N 52 Y	125
N 29 Y	105
N 75 Y	9

417 distance up Mill creek

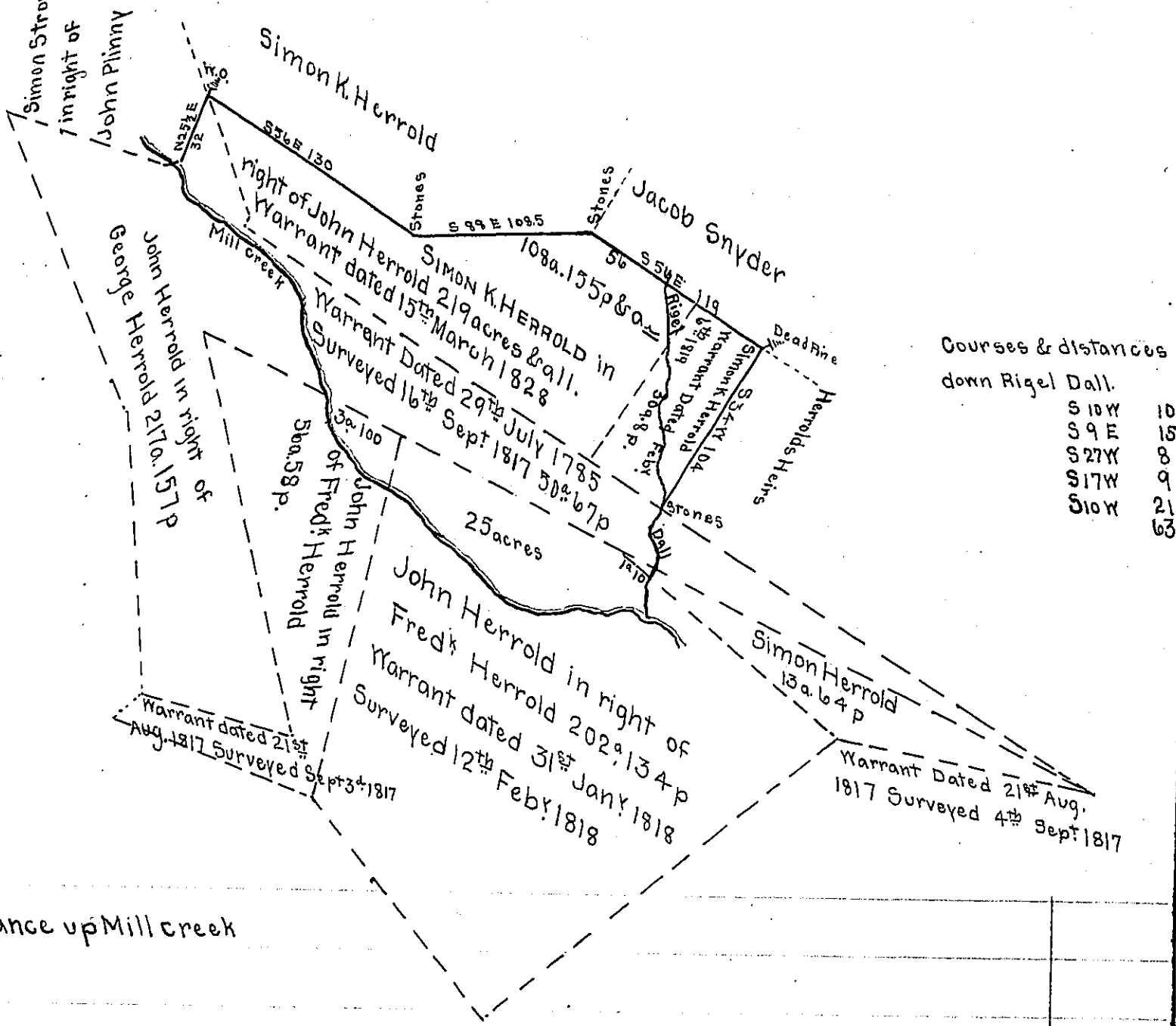

Courses & distances
down Rigel Dall.

S 10 W	10
S 9 E	15
S 27 W	8
S 17 W	9
S 10 W	21
	63

Situate in Chapman township Union County Containing two hundred & nine-
teen acres and the usual allowance of Six per cent for roads &c. Surveyed
for Simon K. Herrold in conformity to the last Will & Testament of
Herrold late of said township Deceased May 8th AD. 1850.

To John Laporte Esq^r }
Surveyor General

James Madden. D.S.

IN TESTIMONY that the above is a copy of the original remaining on file in
the Department of Internal Affairs of Pennsylvania, made
conformably to an Act of Assembly approved the 16th day of
February, 1833, I have hereunto set my Hand and caused
the Seal of said Department to be affixed at Harrisburg,
this twentieth day of March 1905

Leach R. Brown
Secretary of Internal Affairs.